



2P/40A

### Technical Data

|                     |  |  |
|---------------------|--|--|
| Electrical Features | Voltage rating(Ue)   | 250V AC                                    |
|                     | Frequency  | 50/60Hz                                    |
|                     | Endurance(O-C)   |  |
|                     | Electrical life  | 100,000                                    |
|                     | Maximum number of switching operation a day                                    | 100  |
|                     | Additional characteristics   |  |
|                     | Insulation vwltag(Ui)  | 500V AC                                    |
|                     | Pollution degree   | 2  |
|                     | Rated impulse withstand voltage(Uimp)  | 2.5kV(4kV@ 12/24/48VAC)                    |
|                     | Degree of protection (IEC 60529)   | IP20<br>IP40                               |
|                     | Operating temperature  | -5°C~+60°C(1)                              |
|                     | Storage temperature  | -40°C~+70°C                                |
|                     | Tropicalization(IEC 60068-1)   | Treatment 2(relative humidity 95% at 55°C) |
|                     | ELSV compliance(Extra Low Safety Voltage)for 12/24/48VAC versions              |  |
|                     | The product control conforms to the SELV(safety extra low voltage)requirements |  |

(1)In the case of contactor mounting in a enclosure for which the interior temperature is in range between 50°Cand 60°C, it is necessary to use a spacer, between each contactor

# STMF

Modular Contactor

## Consumption

| STMF<br>Automatic<br>Control<br>Contactor<br>-50Hz | 2P | Rating(In) |       | Control voltage(VAC)(50/60 Hz) | Consumption |        | Max. power |
|--|----|------------|-------|--------------------------------|-------------|--------|------------|
|  |    | AC-7a      | AC-7b |                                | Holding     | Inrush |            |
|  |    | 40A        | 18A   | 220...240                      | 4.6VA       | 34VA   | 1.6W       |

## Circuit Diagram

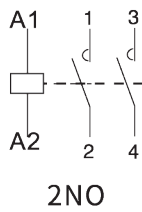

## Overall and Installation Dimension(mm)

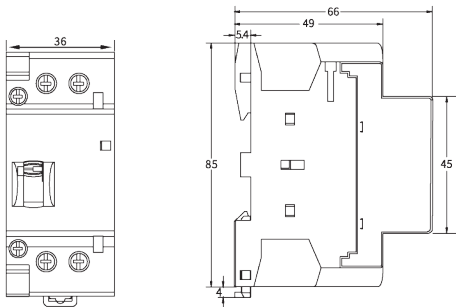

STMF-40A